

# UniCure

## SPRAYBOOTHS

### e-SPRAY ES300SDP

#### Semi-Downdraft Double Prep Station

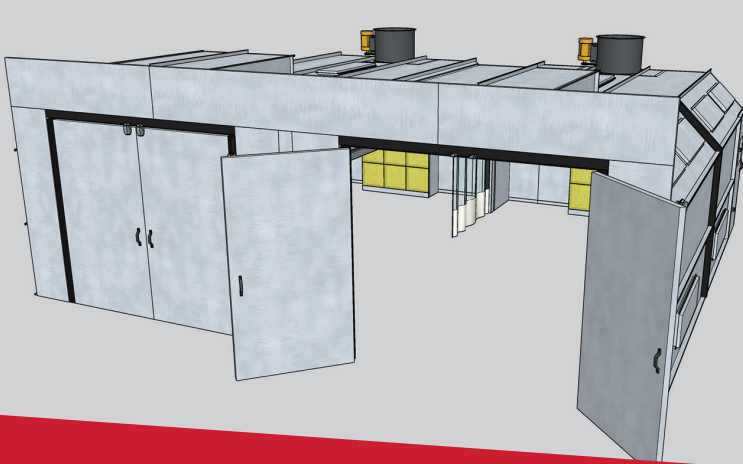

Outside dimensions: 26' 5" x 28' 5" x 11'



Inside dimensions: 26' x 14' x 9' – per side

***Solid Build***

***Excellent Air Flow***

***Superior Lighting***

***Easy & Economical  
to Operate***

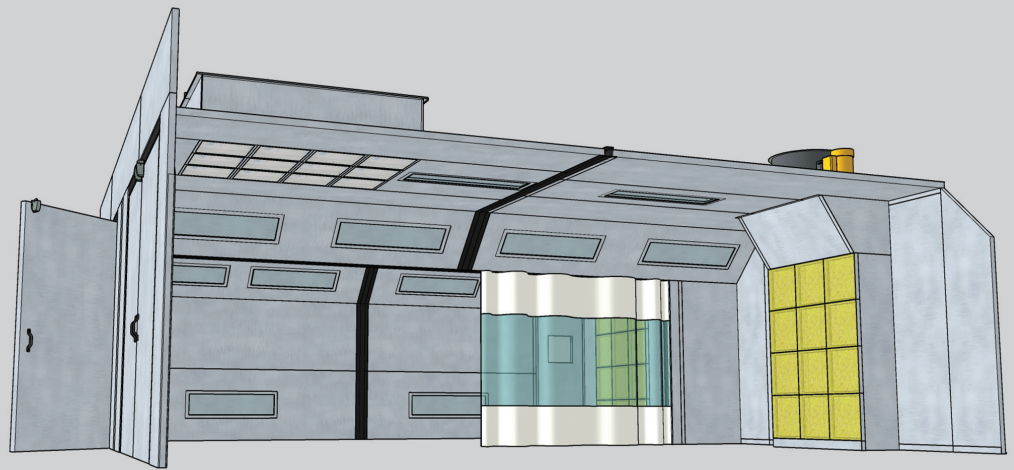

### UniCure ESPRAY 300 Semi-Downdraft Comes Complete

- Galvanized
- Nut & bolt / Tek screw construction
- (2) Front sets of solid product doors without windows
- (2) Personnel doors with windows
- Center divider curtain – 22' x 7'
- (24) 4-tube T8 light fixtures
- (2) 30" exhaust fans with 9' duct packages including clean out and ARV
- (2) Heated air make-up systems at 1.0 MBTU and 10,000 CFM with Deluxe controls
- (2) Heater duct packages with intake and discharge duct
- Optional crossover exhaust plenum, tri-fold doors, and windows

**Inside dimensions:**  
26' x 14' x 9' – per side

**Outside dimensions:**  
26' 5" x 28' 5" x 11'

**Product door opening:**  
9' 4" W x 8' 10" H

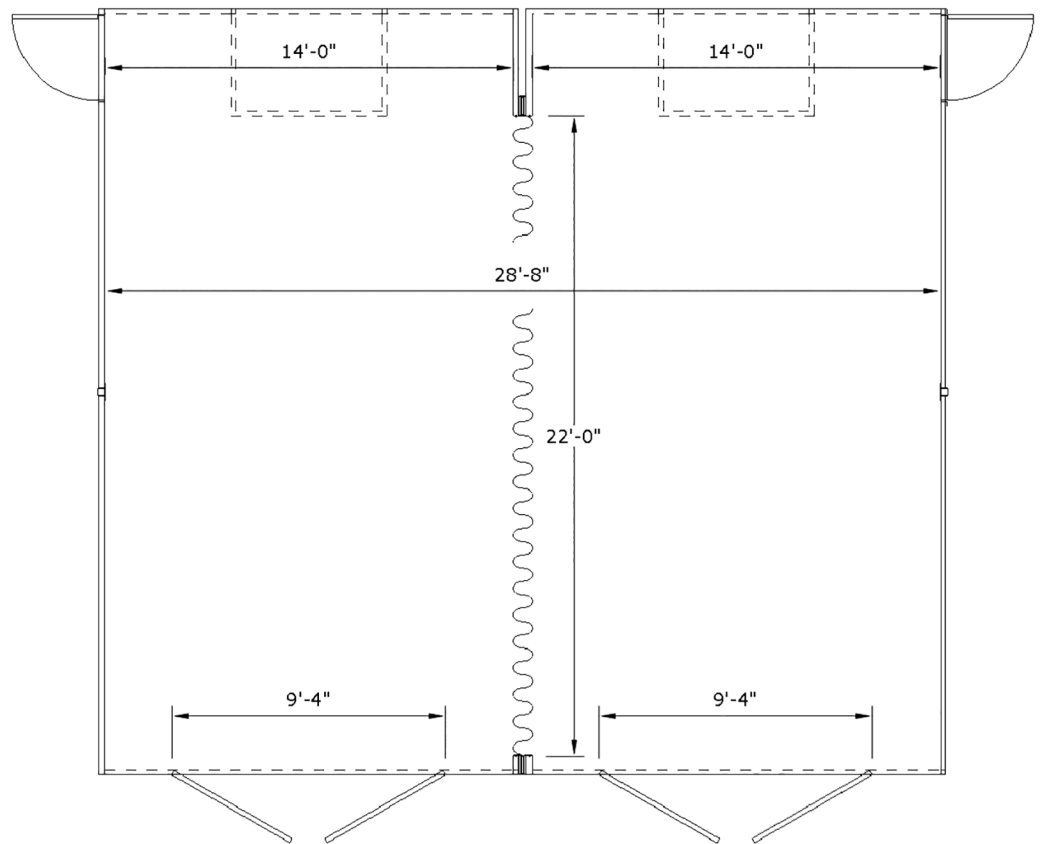

- The prep station construction and exhaust air flow velocities are designed to meet or exceed OSHA standards.
- This prep is constructed of 18 gauge galvanized sheet steel powder coated white inside and out, with interlocking flange edges that are fastened together with self tapping speed screws. Panels have exterior flanges to provide a smooth interior surface.
- The doors are built with two inch by two inch square tube frames for heavy duty service, and have a lip air seal. Two 36" X 84" personnel access doors are standard. The doors are located on either side to meet user requirements.
- Preps require electrical connections to the fan and light fixtures, mechanical duct system connections for air discharge to the outside, and hardware for anchoring the product to the floor.
- Caulking, rubber seals for doors, fasteners, and all necessary hardware for complete mechanical installation are furnished with all units.
- Specifications subject to change without notice.

**AMERICAN MADE**  
**[www.spraybooths.com](http://www.spraybooths.com)**