

UniCure

SPRAYBOOTHS

ZAPPER XL

DOWNDRAFT SPRAYBOOTHS

Do you paint the vehicle and individual parts at the same time?

XTRA LENGTH

- Space for the vehicle and separate parts

XTRA FUNCTIONS

- Use the whole booth OR choose the vehicle end or the parts end

XTRA PRODUCTIVITY

- Dual Parts Doors allow for easy access into the booth



- Solid Build
- Excellent Air Flow

- Superior Lighting
- Easy & Economical to Operate

- Powder Coated White
- Waterborne Controls



This UniCure Downdraft Comes Complete

- All Necessary Fasteners and Sealing Materials
- 18 - 4 Tube Florescent Light Fixtures
- Tri-Fold Product Doors with Windows
- 1 Personnel Door with Window
- 4 - 24" Exhaust Fans with Motors
- 2 Extra Sections of Exhaust Duct Per Stack
- 4 Exhaust Duct with Clean-Out
- 4 Automatic Exhaust Air Ventilators
- All Necessary Filters



Available Single or Double Wall
Downdraft Side Exhaust
Downdraft Pit Model

UniCure
Spraybooths Prep Stations

INTERSTATE MARKETING CORPORATION
104 SPENCE LANE, NASHVILLE, TN 37210

Your Collision and Repair Equipment Headquarters

Call Toll Free: 1-800-868-3033 • TN (615) 889-3330
email: unicure@spraybooths.com • www.spraybooths.com

UniCure

Downdraft Side Exhaust

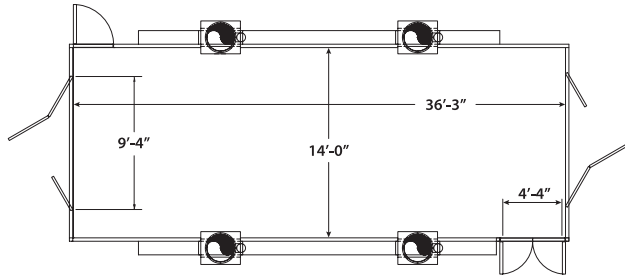

Single Wall 1006XL
Double Wall 3006XL

UniCure

Downdraft Pit Model

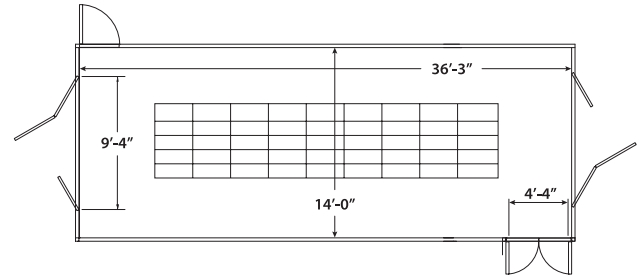

Single Wall 1007XL
Double Wall 3007XL

Outside Dimensions

Length 36'-9"
Width 16'-6"
Height 11'-0"

Inside Dimensions

Length 36'-3"
Width 14'-0"
Height 9'-0"

Outside Dimensions

Length 36'-9"
Width 14'-6"
Height 11'-0"

Inside Dimensions

Length 36'-3"
Width 14'-0"
Height 9'-0"

Product Doors

Height 9'-0"
Width 9'-4"

Personnel Door

Height 7'-0"
Width 3'-0"

Parts Doors

Height 7'-0"
Width 4'-4"

- The spraybooth construction and exhaust air flow velocities are designed to meet or exceed OSHA standards.
- This booth is constructed of 18 gauge galvanized sheet steel powder coated white inside and out, with interlocking flange edges that are fastened together with self tapping speed screws. Panels have exterior flanges to provide a smooth interior surface.
- The doors are built with two inch by two inch square tube frames for heavy duty service, and have a lip air seal. One 36" X 84" personnel access door is standard. The door can be located on either side to meet user requirements.
- Booths require electrical connections to the fan and light fixtures, mechanical duct system connections for air discharge to the outside, and hardware for anchoring the booth to the floor.
- Caulking, rubber seals for doors, fasteners, and all necessary hardware for complete mechanical installation are furnished with all units.
- Specifications subject to change without notice.