

UniCure

Spraybooths

Paint Mixing Room ES8X8MR

The UniCure ES8X8MR is an economical model that assembles easily. It is constructed of 18 gauge galvanized steel panels and comes with all the necessary fasteners and sealing materials. The personnel door is 3'0" and includes a window.

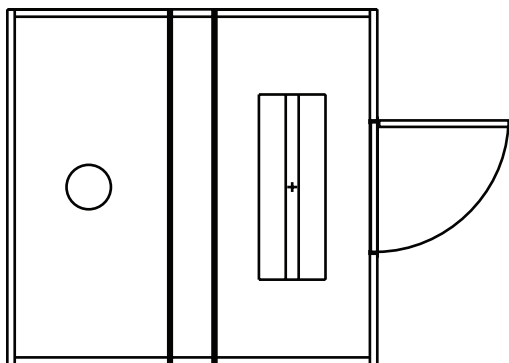

TOP VIEW

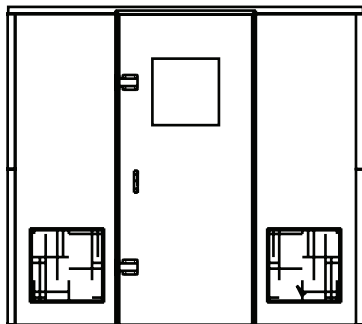

FRONT VIEW

Outside Dimensions

Length: 8'-0"
Width: 8'-0"
Height: 7'-2"

Inside Dimensions

Length: 7'-8"
Width: 7'-8"
Height: 7'-0"

e-Spray

by UniCure
economy made easy!



Shown with Optional
Powder Coating

Included:

- Galvanized Steel Panels
- Fasteners and Sealing Material
- Personnel Door with 18" x 18" Window
- (1) 48" 4 Tube Light Fixture with Tubes
- (1) 12" Tubeaxiel Fan with 1 PH Motor
- Filers Intake/Exhaust

Available Options:

- Powder Coating
- Exhaust Ducting

UniCure

Spraybooths

INTERSTATE MARKETING CORPORATION

104 Spence Lane, Nashville, TN 37210
Your Collision Repair Equipment Headquarters
Call Toll Free: 1-800-868-3033 • TN (615) 889-3330
e-mail: unicure@spraybooths.com • www.spraybooths.com